

General Notes:

1. All walls to be inspected and approved by geotech and structural engineer.
2. Ensure positive drainage behind all walls and throughout site.
3. All walls to conform to West Vancouver municipal bylaws and Rodgers Creek Design Guidelines
4. all landscape works (including boulevard areas) to be automatically irrigated
5. Where soft landscape areas meet building foundation wall, 12-18" wide gravel drain strip to be installed at landscape grade.
6. Paving Surfaces:
 - a) Stair Landings: Standard pavers; Colour: Desert Sand Blend (or equivalent); Pattern: running bond
 - b) Stair Treads: 18" x 18" Hydrapressed slabs mortared in place; Colour: Desert Sand - cut to fit
 - c) Decks and Patios: 18" x 18" Hydrapressed slabs on pea gravel; Colour: Desert Sand
 - d) Autocourt: Aquapave, Old Country Stone; Pattern: random cobble w/ soldier source edge; Colour: 70/30 % mix of Taupe (70) and Desert Sand (30)
7. Handrails installed where required by code.

Pool Notes:

1. All work to meet applicable building code & municipal regulations.
2. All retaining walls to be constructed in accordance with the details and specifications of the engineer's drawing. Finish of walls as per owner's approval.
3. Pool/spa finish and coping to the approval of the owner and consultant.
4. Pool equipment to be located at lower terrace level.
5. Pool area to be fenced to municipal standards with self-closing, self-latching gates. Fence to be a minimum of 3'-6"ht.
6. All finished paving surfaces to the owner's approval.
7. Refer to structural engineer's drawings for pool and mechanical room.
8. Pool walls to be tiled to a minimum 6" below water level.

DRAWING LEGEND:

- imperial design grade (proposed)
 - (metric) road and boulevard design grades provided by InterCAD consulting engineers
 - c.i.p. masonry retaining walls with granite cladding as per BPP guidelines
 - split-faced blast rock walls as per BPP guidelines, max. 5' ht.
 - round boulder 'rockery' style wall as per BPP guidelines max 2' ht
- * NOTE: ALL WALLS TO BE ENGINEERED ***

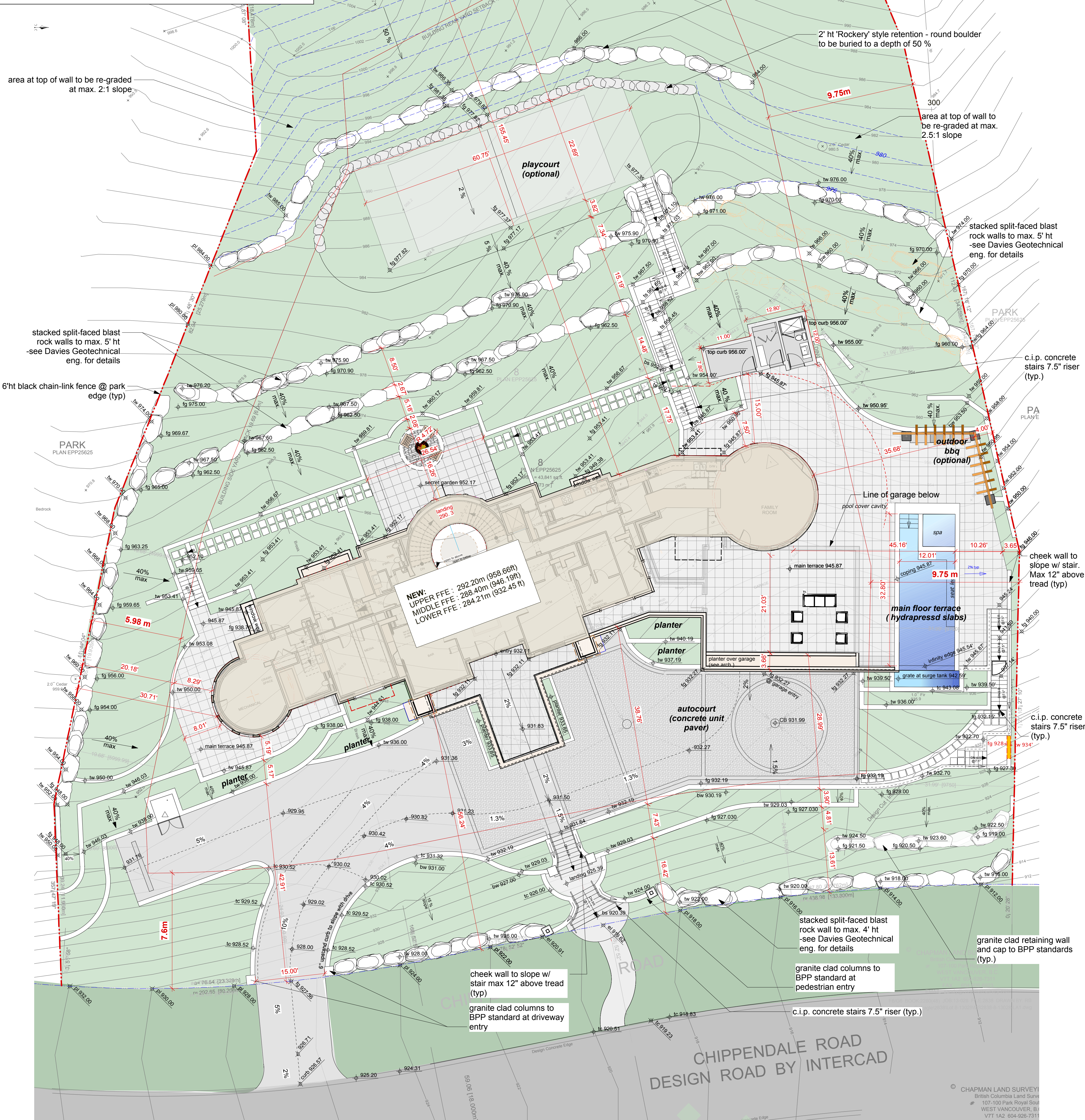

NEW:
 UPPER FFE: 292.20m (958.66ft)
 MIDDLE FFE: 288.40m (946.19ft)
 LOWER FFE: 284.21m (932.45ft)

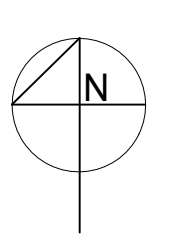

consultants:
 Creekside Architects
 Davies Geotechnical Eng.
 InterCAD Services Ltd.

project:
 RODGERS CREEK AREA 3
 LOT 8
 2915 CHIPPENDALE ROAD
 WEST VANCOUVER

revisions:
 1. issued for review Jan 26, 2012
 2. issued to InterCAD for coordination July 6, 2012
 3. north walls revised, re-issued to InterCAD Aug 20, 2012
 4. for client review Sept 13, 2013
 5. issue for Building Permit Oct 14, 2013
 6. revised as per DWV comments, Jan 27, 2014
 7. tw grades adjusted SE corner as per DWV Feb 14, 2014
 8. SE wall switched to blast-rock May 2014
 9. pool bunker location/dimensions revised Sept 22, 2014
 10. issue to BPP May 12, 2015
 11. issue to BPP July 20, 2015

GRADING/LAYOUT PLAN

drawn: AWC/V
checked: BH
date: May 12, 2012
scale: 3/32"=1'-0"

Copyright reserved. This drawing and design is the property of Forma Design Inc. and may not be used without Landscape Architect's written permission.
 Contractors shall verify and be responsible for all dimensions on the job and the office shall be informed of any changes made on site.
project no: L1 of 3

209-828 Harbourside Dr.
 North Vancouver
 British Columbia
 Canada V7P 3R9
 tel 604-986-9193
 fax 604-986-7320

FORMA DESIGN INC.
 www.formadesign.ca

CHAPMAN LAND SURVEY
 British Columbia Land Survey
 107-100 Park Royal South
 WEST VANCOUVER, B.C.
 V7T 1A2 604-926-7311
 PLAN 2012-00000

ID	Latin Name	Common Name	Quantity	Scheduled Size
TREES (DECIDUOUS & CONIFEROUS)				
AC	Acer circinatum	Vine Maple	17	2.5m ht.
AmG	Acer ginnala	Amur Maple	2	2.5m ht.
AxG	Amelanchier x grandiflora	Apple Serviceberry	6	2.5m ht.
Cob	Chamaecyparis obtusa	Hinoki cypress	4	2.5m
MST	Magnolia stellata	Star Magnolia	5	2.5m
PAR	Parrotia persica	Persian Ironwood	4	6cm cal.
POM	Picea omorika	Serbian Spruce	6	3.0m
PC2	Pinus contorta var. contorta	Shore Pine	11	5 gal.
PIO	Pinus contorta var. contorta	Shore Pine	3	3.0m
PIF	Pinus flexilis 'Vanderwolf's Pyramid'	Vanderwolf's Pyramid Limber Pine	5	3.0m
PIN	Pinus nigra 'Select Green'	Austrian Pine	14	#5 pot
PID	Pinus parviflora	Japanese White Pine	3	3.0m
SJ	Styrax japonicus	Japanese Snowbell Tree	3	6cm cal.
SHRUBS				
Arb	Arbutus unedo 'Compacta'	Compact Strawberry Bush	99	#3 pot
Bx	Buxus microphylla	Littleleaf Boxwood	380	#2 pot
cbp	Callicarpa bodinieri 'Profusion'	Profusion Beautyberry	31	#1 pot
Cor	Cornus sericea	Red Twig Dogwood	116	#1 pot
Cac	Corylus avellana 'Contorta'	Harry Lauder's Walkingstick	1	B&B 1.5 m ht
gs	Gaultheria shallon	Salal	525	#1 pot
Hol	Holdiscus discolor	Oceanspray	18	#2 pot
Hya	Hydrangea paniculata	Hardy Hydrangea	6	#2 pot
hyl	Hydrangea paniculata 'Limelight'	Limelight Hardy Hydrangea	12	#2 pot
lc	Ilex crenata 'Convexa'	Convexa Japanese Holly	13	#2 pot
Jcv	Juniperus chinensis 'Spartan'	Chinese Juniper	12	B&B 1.5 m ht
Lpa	Lonicera pileata	Privet honeysuckle	176	#1 pot
Ma	Mahonia aquifolium	Oregon Grape Holly	30	#1 pot
Mn	Mahonia nervosa	Dwarf Oregon Grape	61	#2 pot
Phs	Physocarpus opulifolius 'Coppertina'	Ninebark	30	#2 pot
Pim	Pinus mugo 'mugo'	Mugo Pine	85	#5 pot
Ris	Ribes sanguineum	Red Flowering Currant	86	#2 pot
Ro1	Rosa rugosa 'Purple Pavement'	Purple pavement Rugosa Rose	59	#2 pot
slx	Salix purpurea 'Nana'	Dwarf Arctic Blue Leaf Willow	216	#2 pot
sbT	Spiraea betulifolia 'Tor'	Tor Birchleaf Spirea	94	#1 pot
Spa	Spiraea x bumalda 'Anthony Waterer'	Anthony Waterer Spirea	204	#2 pot
Sym	Symphoricarpos alba	Snowberry	106	#2 pot
Txh	Taxus x media 'Hicksii'	Hick's Yew	86	B&B 1.2 m ht
PERENNIALS & GROUNDCOVERS				
aju	Ajuga reptans 'Rubra'	Bugleweed	91	#1 pot
ahj	Anemone hybrida 'Honorine Jobert'	Honorine Jobert Windflower	34	#1 pot
ar	Arctostaphylos uva-ursi 'Vancouver Jade'	Bearberry, Kinnikinnick	348	#1 pot
ll	Lavandula latifolia	English Lavender	214	#1 pot
pol	Polystichum munium	Sword fern	84	#1 pot
ORNAMENTAL GRASSES & BAMBOOS				
helo	Helictotrichon sempervirens	Blue Oat Grass	255	#1 pot
ssa	Sesleria autumnalis	Autumn Moor Grass	382	#1 pot
stb	Stipa brachytricha	Korean Feather Reed Grass	10	#1 pot
RIPARIAN				
cks	Carex kelloggii	Kellogg's Sedge	84	#1 pot
cxo	Carex obovata	Slough Sedge	159	#1 pot
irs	Iris sibirica	Siberian Iris	117	#1 pot
ier	Juncus effusus	Common Rush	121	#1 pot

- Planting Notes
- All materials and execution of landscape works shall conform to the B.C.S.L.A./B.C.N.T.A. Landscape standard. Refer to written specifications for complete landscape documentation.
 - All landscape works (including boulevard) to be automatically irrigated.
 - The Landscape Contractor shall ensure that the on-site planting medium/soil meets the specification & recommendations of the soil analysis taken at the time of Substantial Completion. All recommendations of the soil analysis shall be executed prior to Final Acceptance of the landscape works by the Consultant and the municipal authorities.
 - Minimum planting medium depths:
lawn - 6"/150mm
groundcover - 12"/300mm
shrubs - 18"/450mm
trees - 24"/600mm (around & beneath rootball)
 - All plant material shall meet minimum size requirements as indicated in plant list. Quality of plant material and grading of site to conform to the B.C.N.T.A. standard for container grown stock.
 - All plant material to be supplied on the job site must be obtained from a nursery participating in the BCLNA Phytophthora ramorum Certification Program. Plant material provided by the contractor found to be carrying Pr will be removed, disposed of and replaced at the contractor's expense.

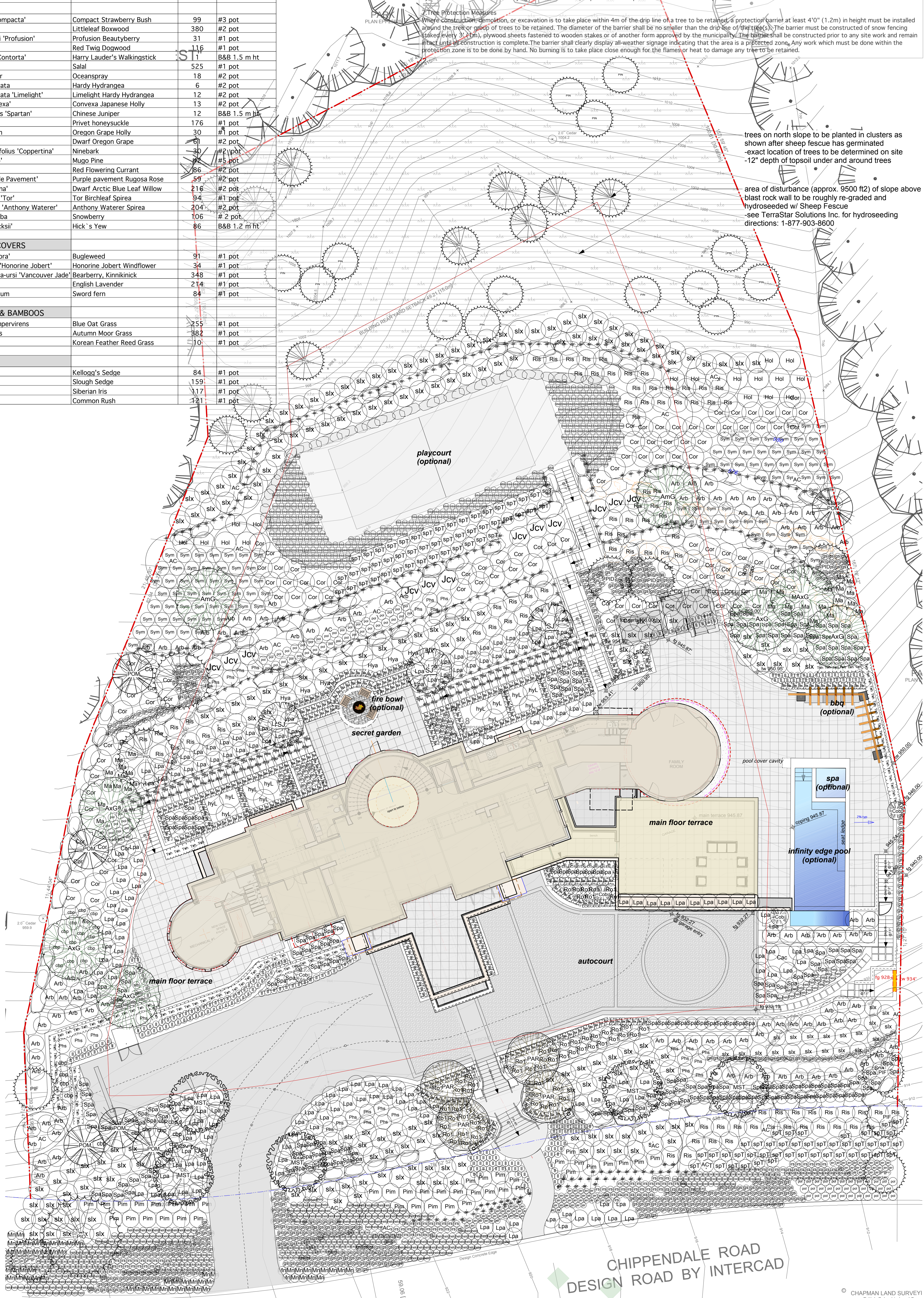

trees on north slope to be planted in clusters as shown after sheep fescue has germinated -exact location of trees to be determined on site -12" depth of topsoil under and around trees

area of disturbance (approx. 9500 ft2) of slope above blast rock wall to be roughly re-graded and hydroseeded w/ Sheep Fescue -see TerraStar Solutions Inc. for hydroseeding directions: 1-877-903-8600

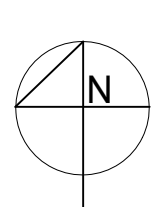

consultants:
**Creekside Architects
Davies Geotechnical Eng.
Intercad Services Ltd.**

project:
**RODGERS CREEK AREA 3
LOT 8
2915 CHIPPENDALE ROAD
WEST VANCOUVER**

revisions:
1. issued for review Jan 26, 2012
2. issued to Intercad for coordination July 6, 2012
3. north walls revised, re-issued to Intercad Aug 20, 2012
4. for client review Sept 13, 2013
5. issue for Building Permit Oct 14, 2013
6. revised as per DWV comments, Jan 27, 2014
7. issued to BPP May 12, 2015
8. issued to BPP July 20, 2015

title:
PLANTING PLAN

drawn:
checked:
date:
scale:

AW/CV
SH
May 12, 2012
3/32"=1'-0"

Copyright reserved. This drawing and design is the property of Forma Design Inc. and may not be used without Landscape Architect's written permission.
Contractors shall verify and be responsible for all dimensions on the job and this office shall be informed of any change made on site.

project no.:
sheet no.:
L2 of 3

209-828 Harbourside Dr.
North Vancouver
British Columbia
Canada V7P 3R9
tel 604-986-9193
fax 604-986-7320

FORMA DESIGN INC.
www.formadesign.ca

CHAPMAN LAND SURVEY
British Columbia Land Survey

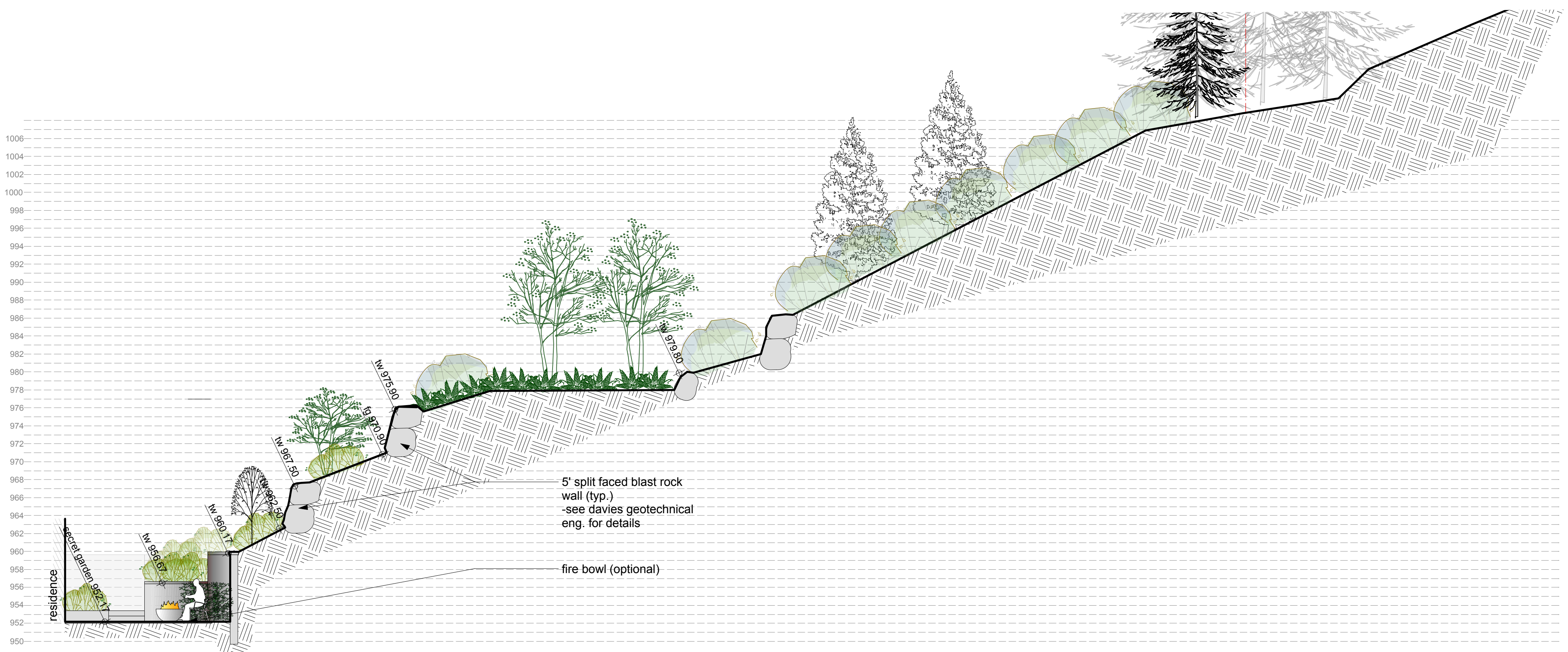

Section A-A
Scale: 1/8"=1'-0"

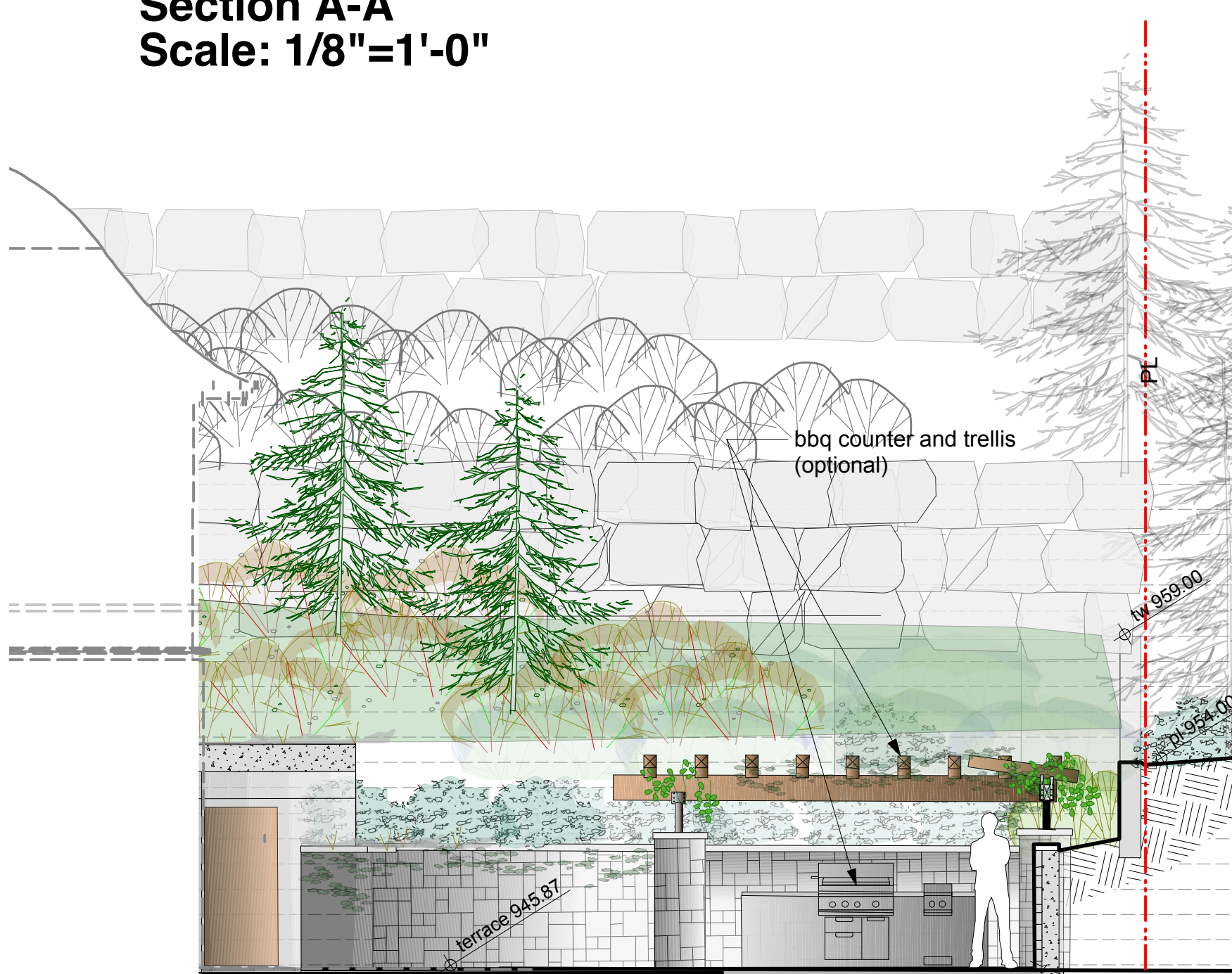

Section B-B
Scale: 3/16"=1'-0"

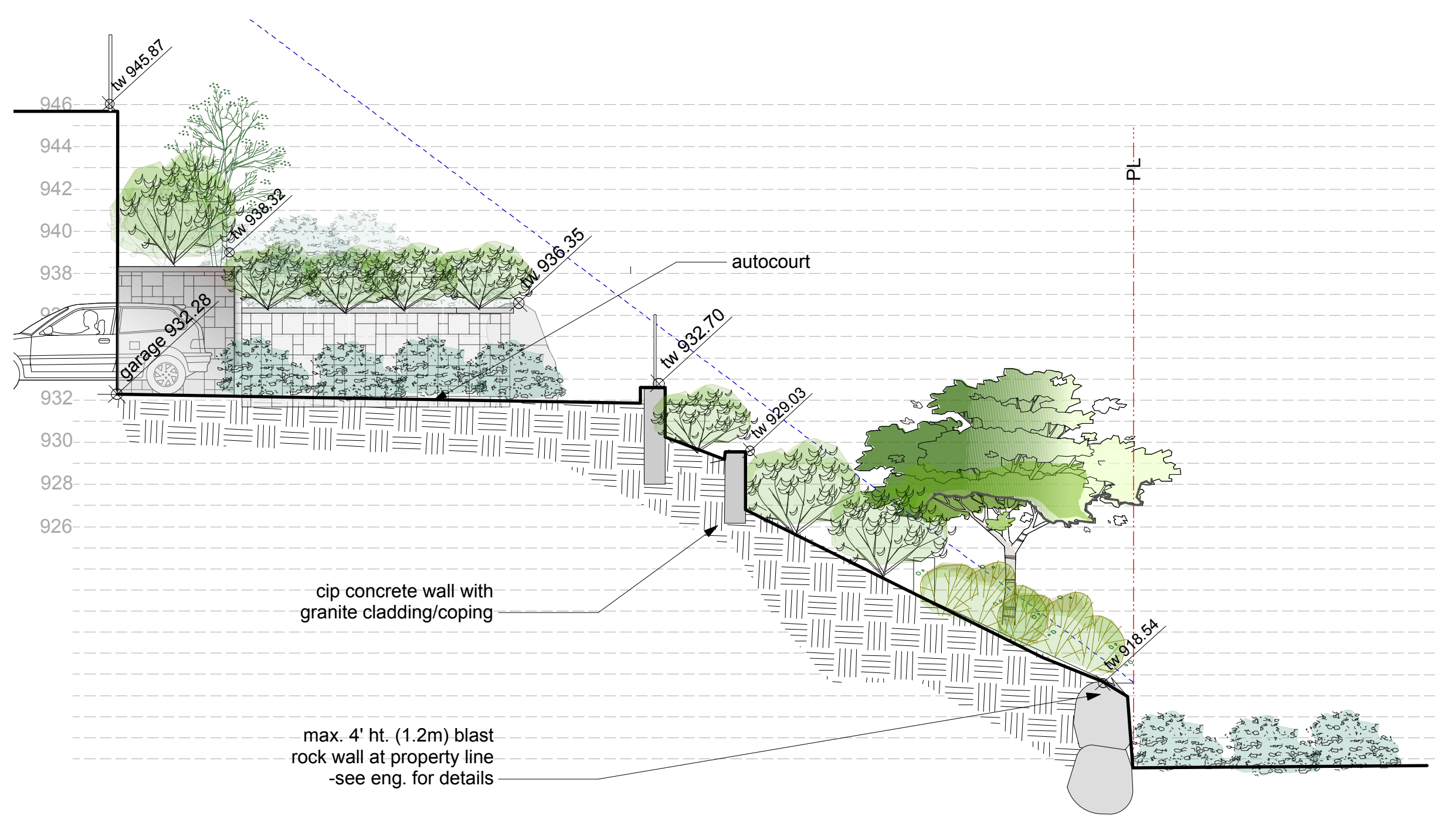

Section C-C
Scale: 3/16"=1'-0"

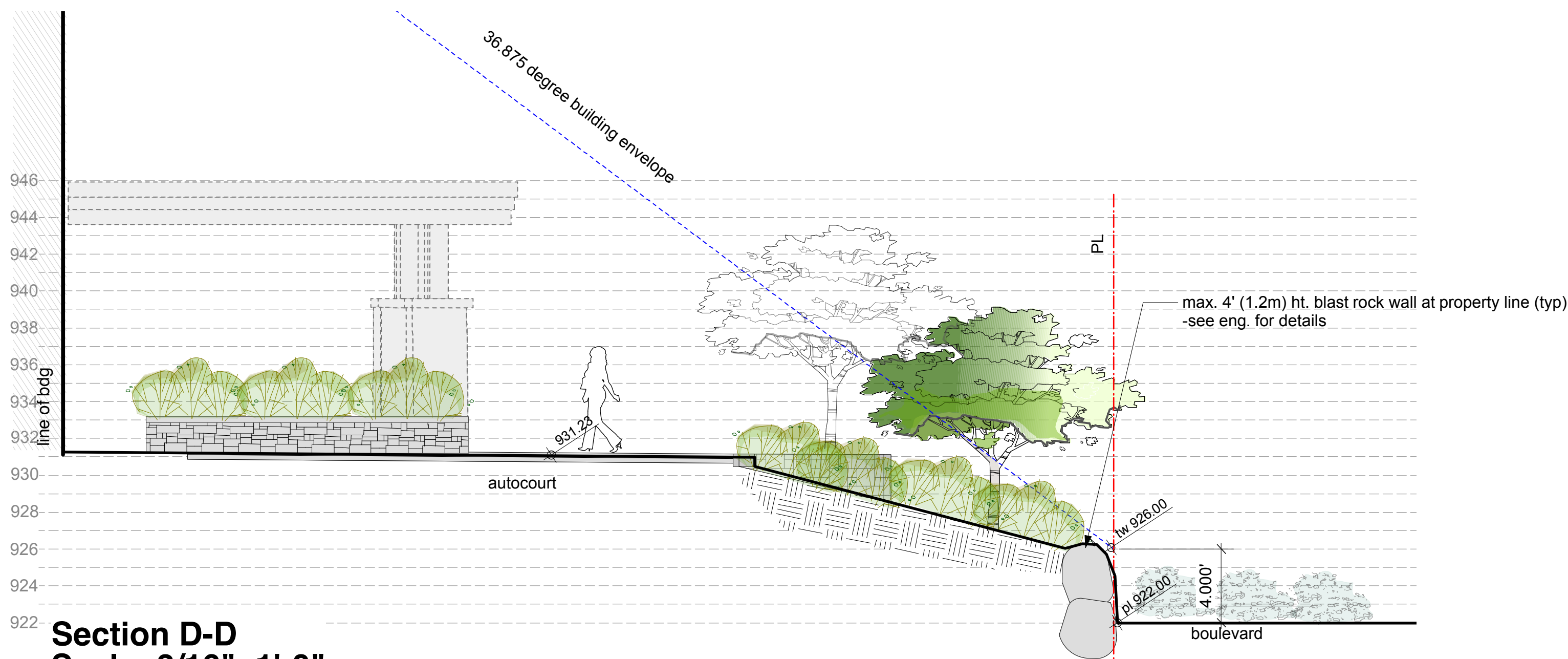

Section D-D
Scale: 3/16"=1'-0"

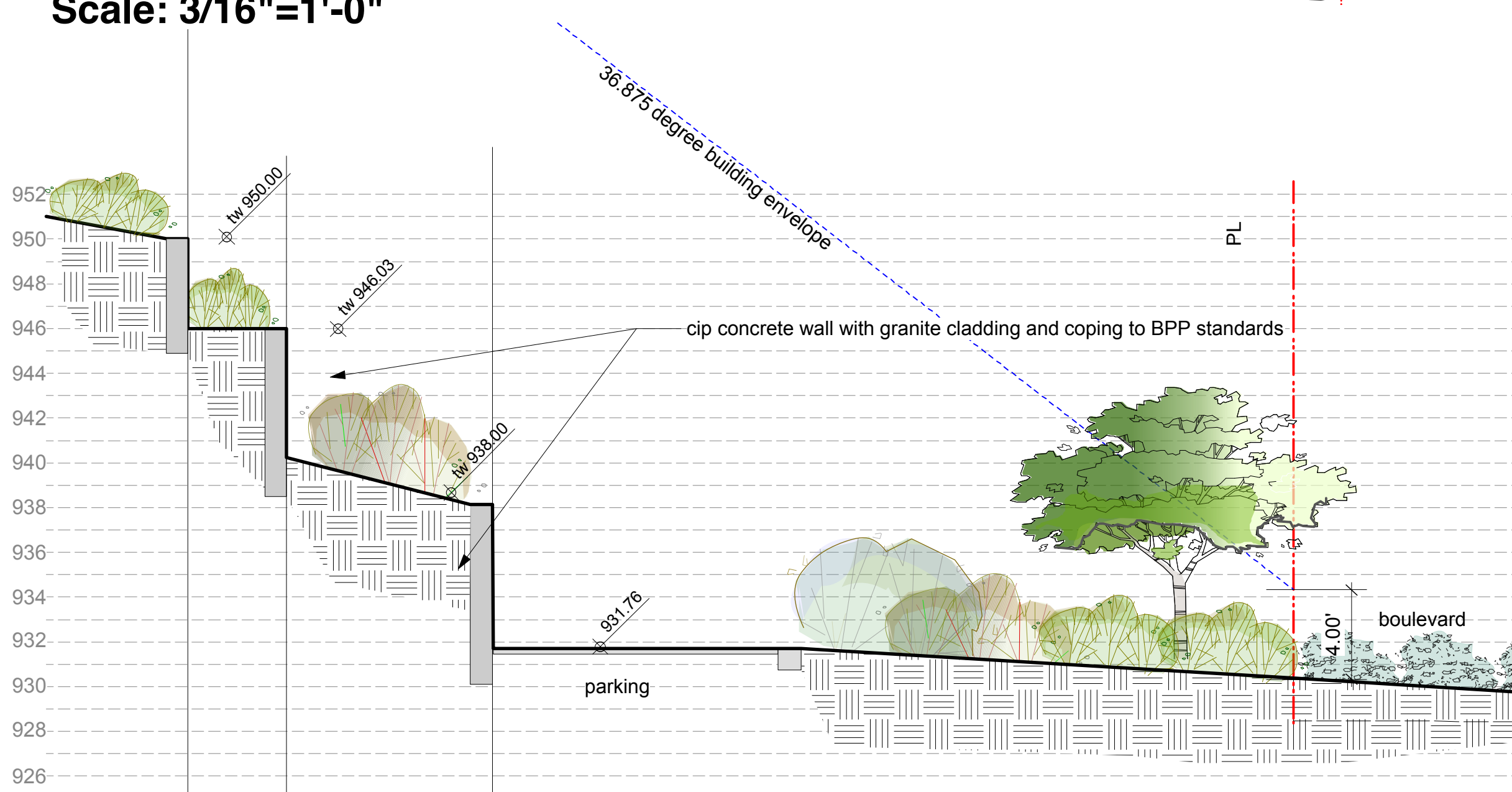

Section E-E
Scale: 3/16"=1'-0"

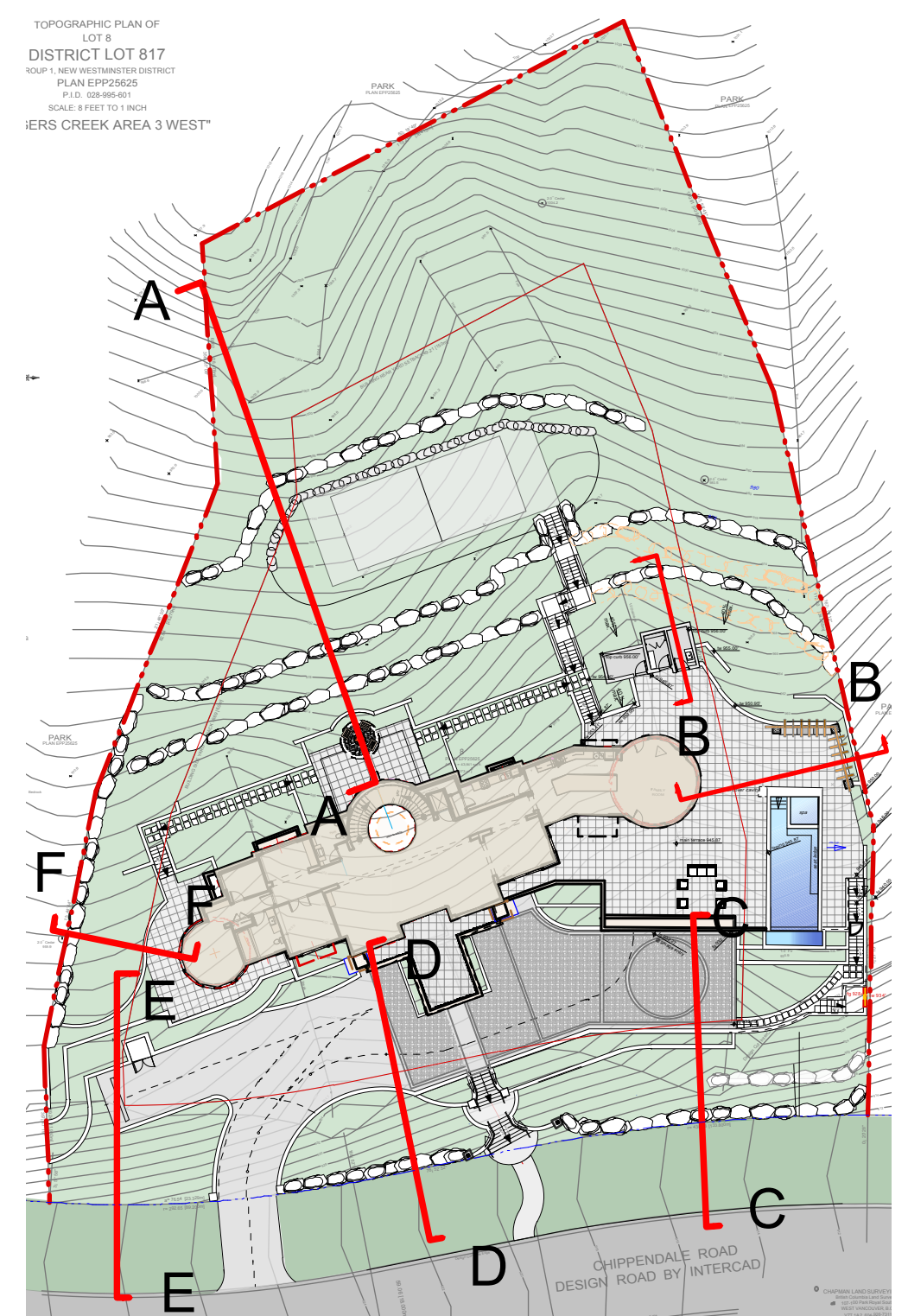

Key Plan
Scale: NTS

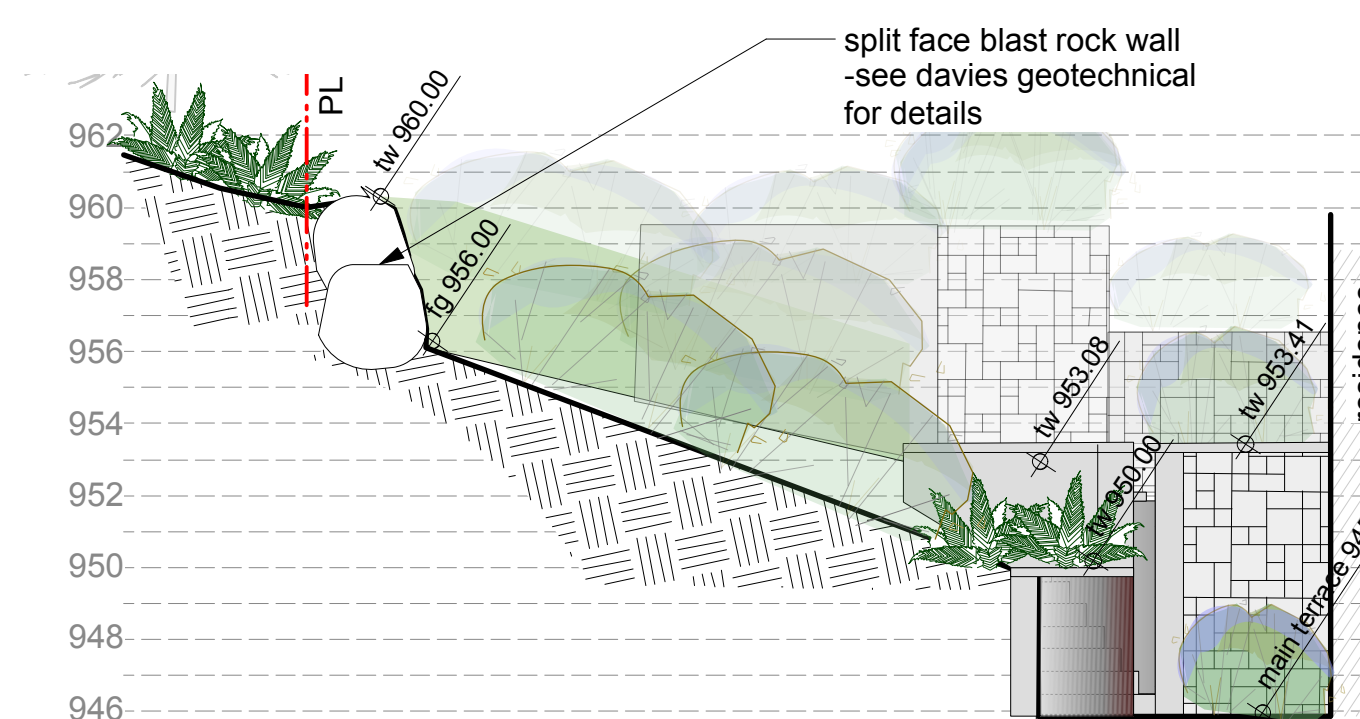

Section F-F
Scale: 3/16"=1'-0"

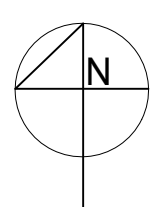

consultants:
Creekside Architects
Davies Geotechnical Eng.
Intercad Services Ltd.

project:
RODGERS CREEK AREA 3
LOT 8
2915 CHIPPENDALE ROAD
WEST VANCOUVER

revisions:
1. issued for review jan 26, 2012
2. issued to intercad for coordination July 6, 2012
3. north walls revised, re-issued to intercad Aug 20, 2012
4. for client review Sept 13, 2013
5. issue for Building Permit Oct 14, 2013
6. revised as per DMV comments, Jan 27, 2014
7. issued to BPP May 12, 2015
8. issued to BPP July 20, 2015

title:
LANDSCAPE SECTIONS

drawn: AW/CV
checked: BH
date: May 12, 2012
scale: AS NOTED

Copyright reserved. This drawing and design is the property of Forma Design Inc. and may not be used without Landscaper's written permission.
Contractors shall verify and be responsible for all dimensions on the job and this office shall be informed of any changes made on site.
project no.: sheet no.:
L3 of 3

209-828 Harbourside Dr.
North Vancouver
British Columbia
Canada V7P 3R9
tel 604-986-9193
fax 604-986-7320

FORMA DESIGN INC.
www.formadesign.ca

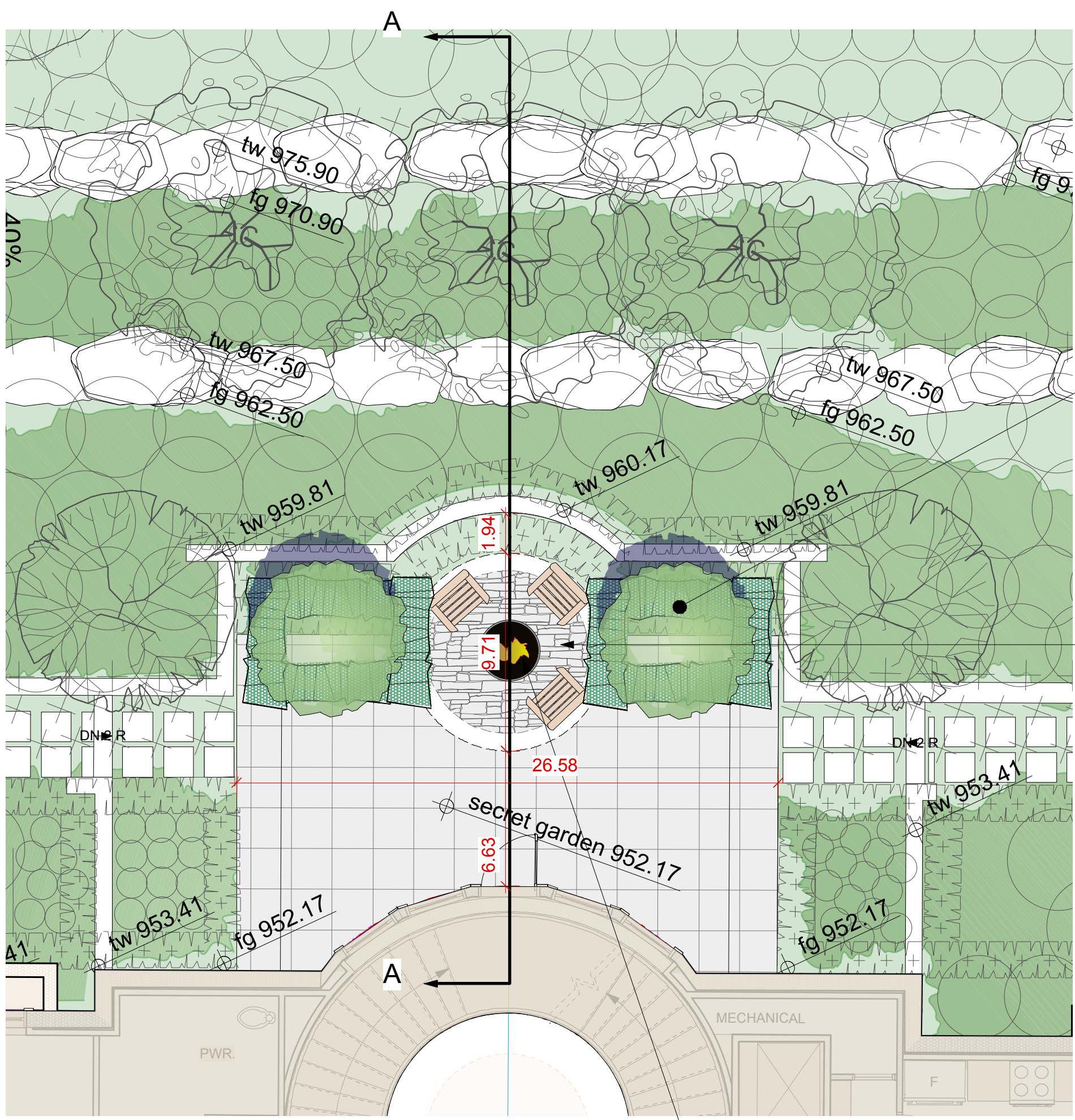

PLAN VIEW - SECRET GARDEN
SCALE: 3/16"=1'-0"

featured paving
- TBD

fire bowl (optional)
- see details this sheet



TREE CONCEPT IMAGES

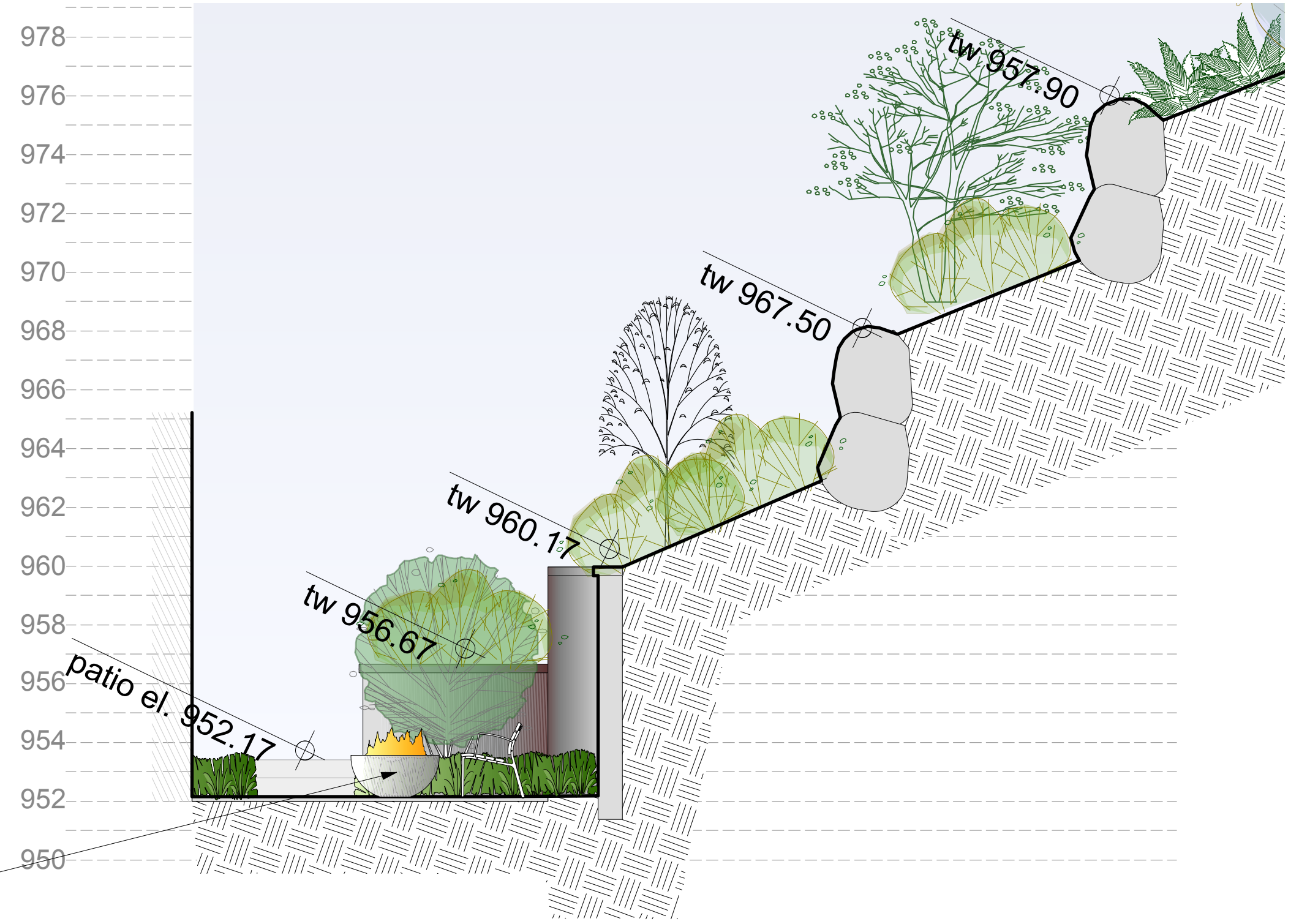

SECTION VIEW A,A- SECRET GARDEN
SCALE: 1/4"=1'-0"



Firebowl
-Hemi 36" from Solus (www.solusdecor.com)
-waterproofed

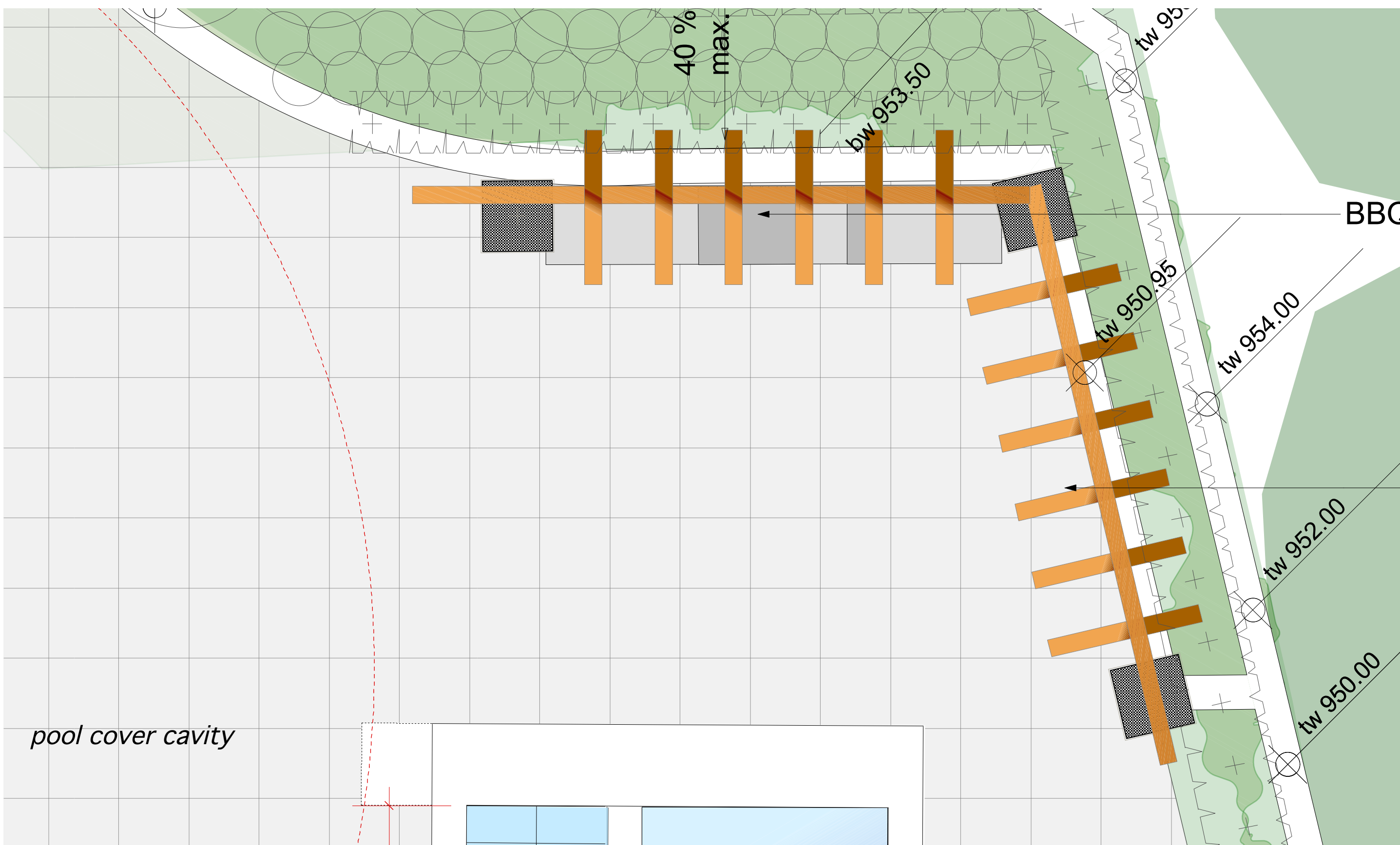

PLAN VIEW - BBQ COUNTER
SCALE: 1/2"=1'-0"

BBQ counter (optional)

overhead trellis

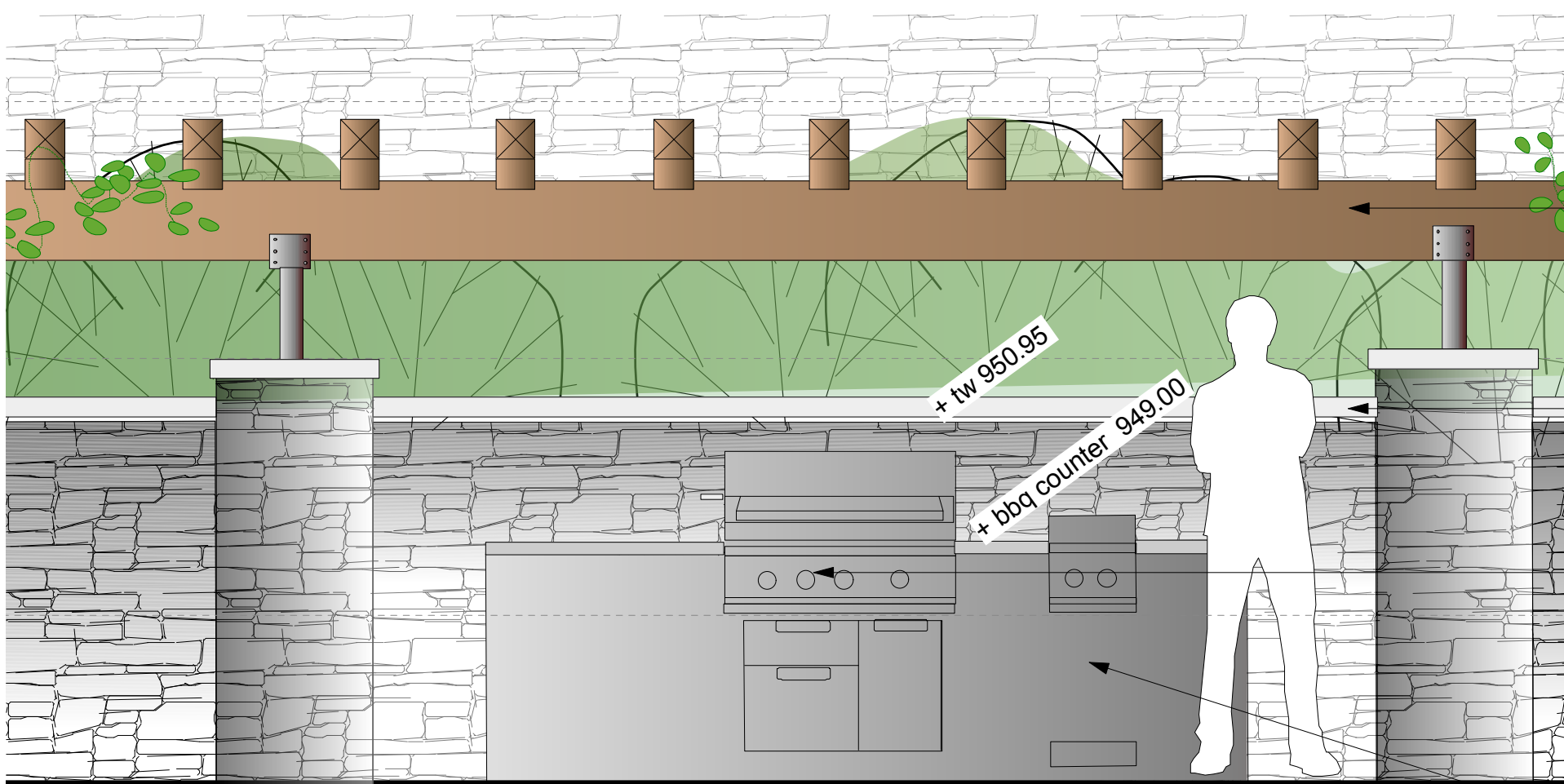

ELEVATION VIEW- BBQ COUNTER
SCALE: 1/2"=1'-0"

overhead trellis

CIP concrete wall with granite cladding and cap (typ.)

professional built in grill island from DCS 48" (or equiv.) c/w side burner
- gas requirements TBD by contractor (natural or propane)
- stainless steel access drawers/doors as required by owner

custom tile face
- tile to be coordinated with architecture and selected by owner (optional)

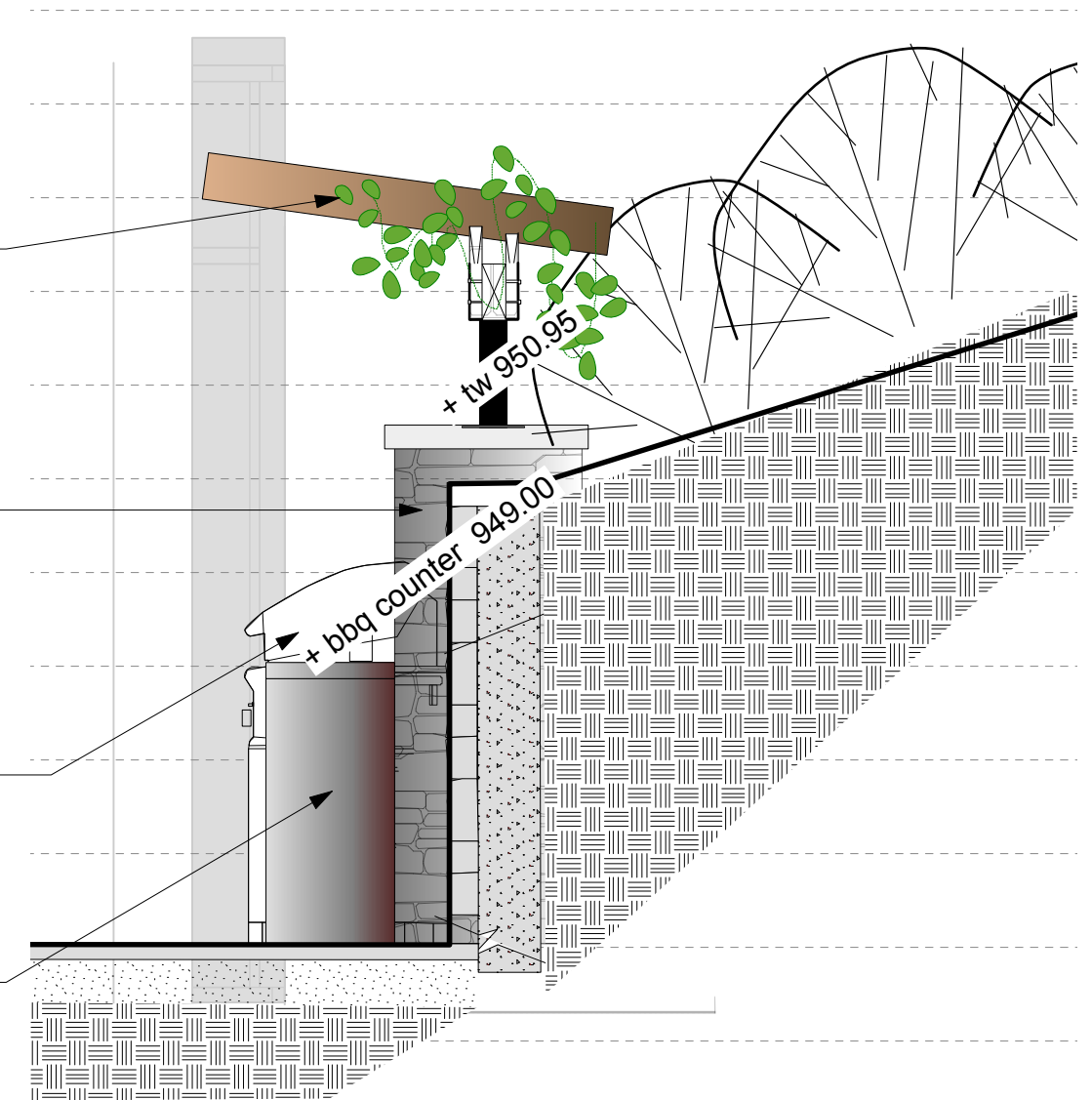

SECTION VIEW- BBQ COUNTER
SCALE: 1/2"=1'-0"

FORMA DESIGN INC.
www.formadesign.ca

209-828 Harbourside Dr.
North Vancouver
British Columbia
Canada V7P 3R9
tel 604-986-9193
fax 604-986-7320

revisions:
1. issued for review May 7, 2013
2. firebowl in secret garden added,
issue to BPP July 20, 2015

consultants:
CREEKSIDE ARCHITECTS
INTERCAD CONSULTING

project:
RODGERS AREA 3
LOT 8
WEST VANCOUVER BC

DETAILS

Scale: as shown
Date: APRIL 25, 2013

Copyright reserved. This drawing and design is the property of Forma Design Inc. and may not be used without LandscapeArchitect's written permission.
Contractors shall verify and be responsible for all dimensions on the job and this sheet shall be informed of any changes made on site.

project no.: sheet no.:
L4.0 DETAILS

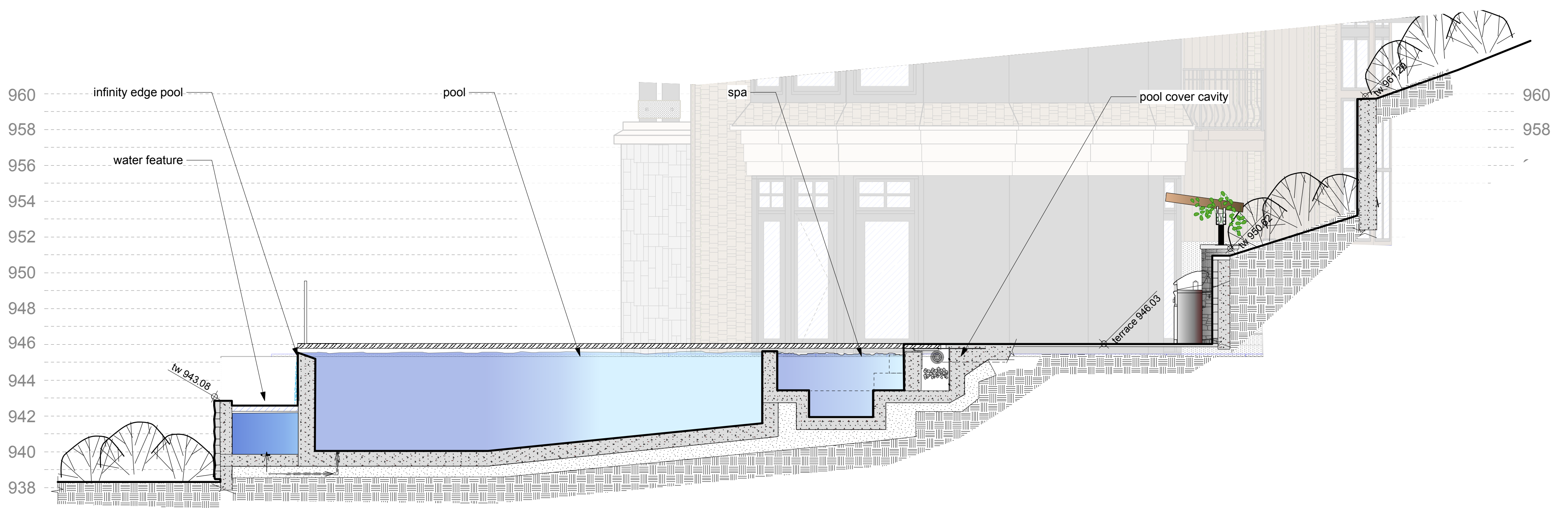

SECTION VIEW C, C- POOL/SPA/WATER FEATURE
SCALE: 1/4"=1'-0"

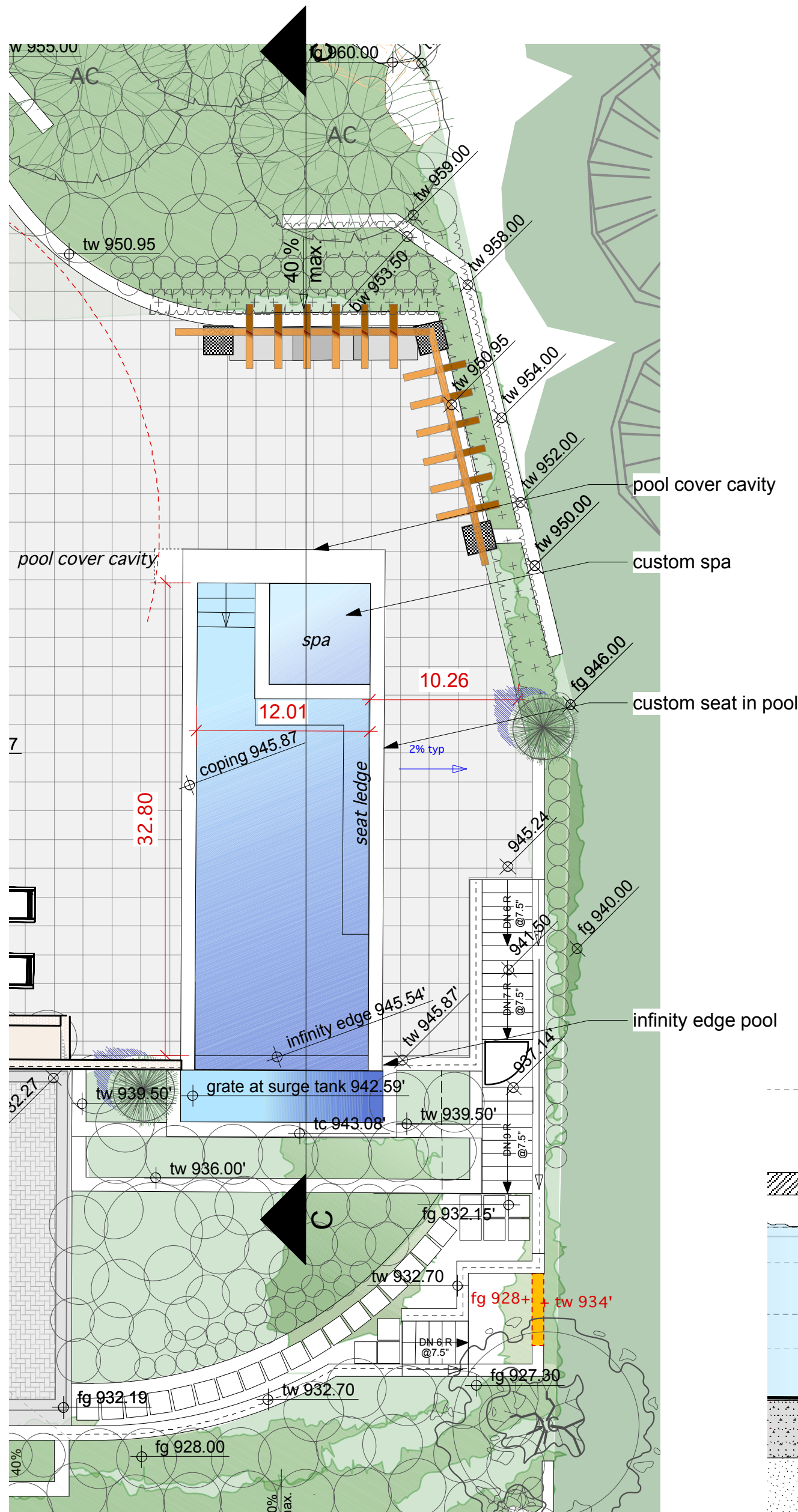

PLAN VIEW- POOL/SPA/WATER FEATURE
SCALE: 1/8"=1'-0"

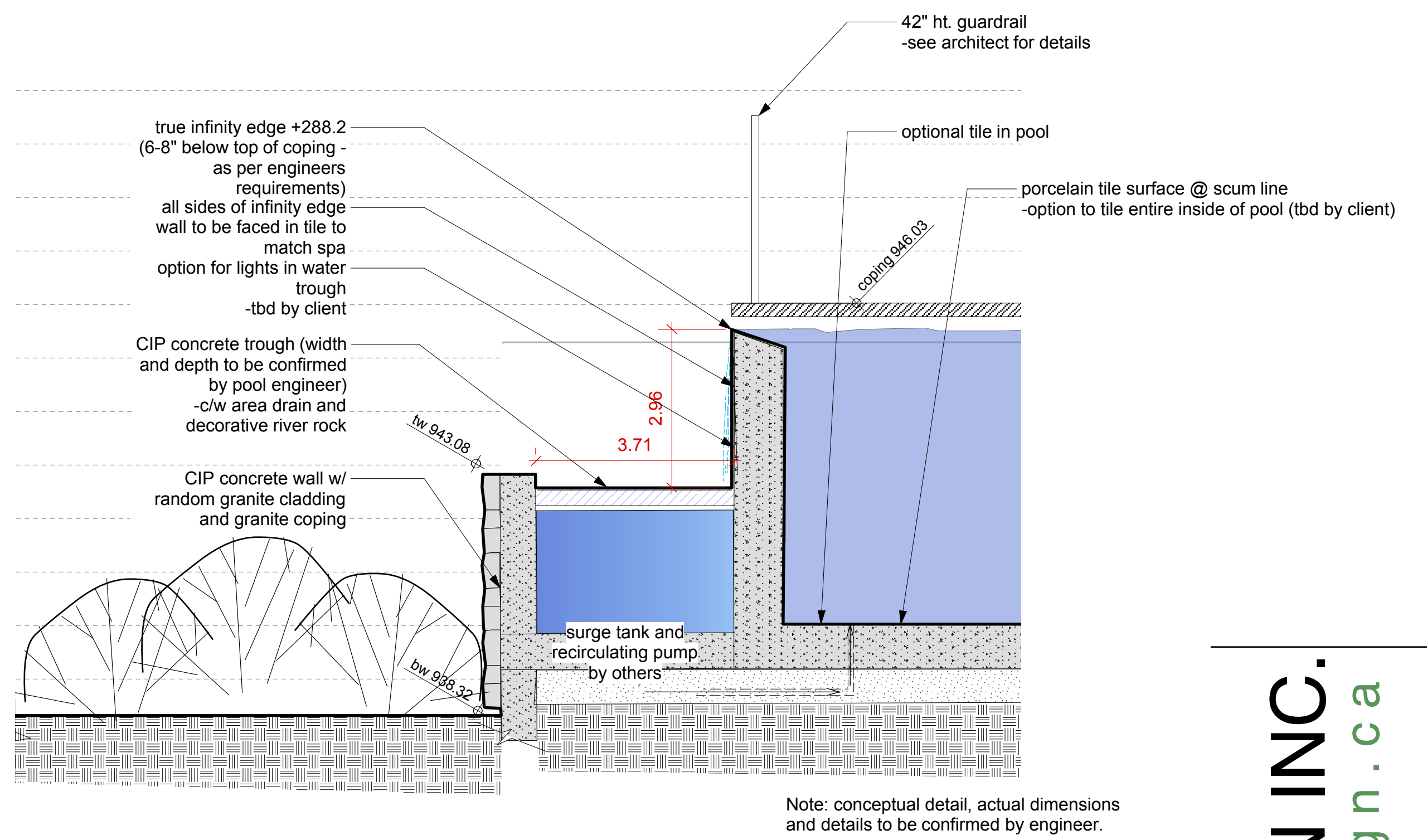

PLAN VIEW- POOL/SPA/WATER FEATURE
SCALE: 1/2"=1'-0"

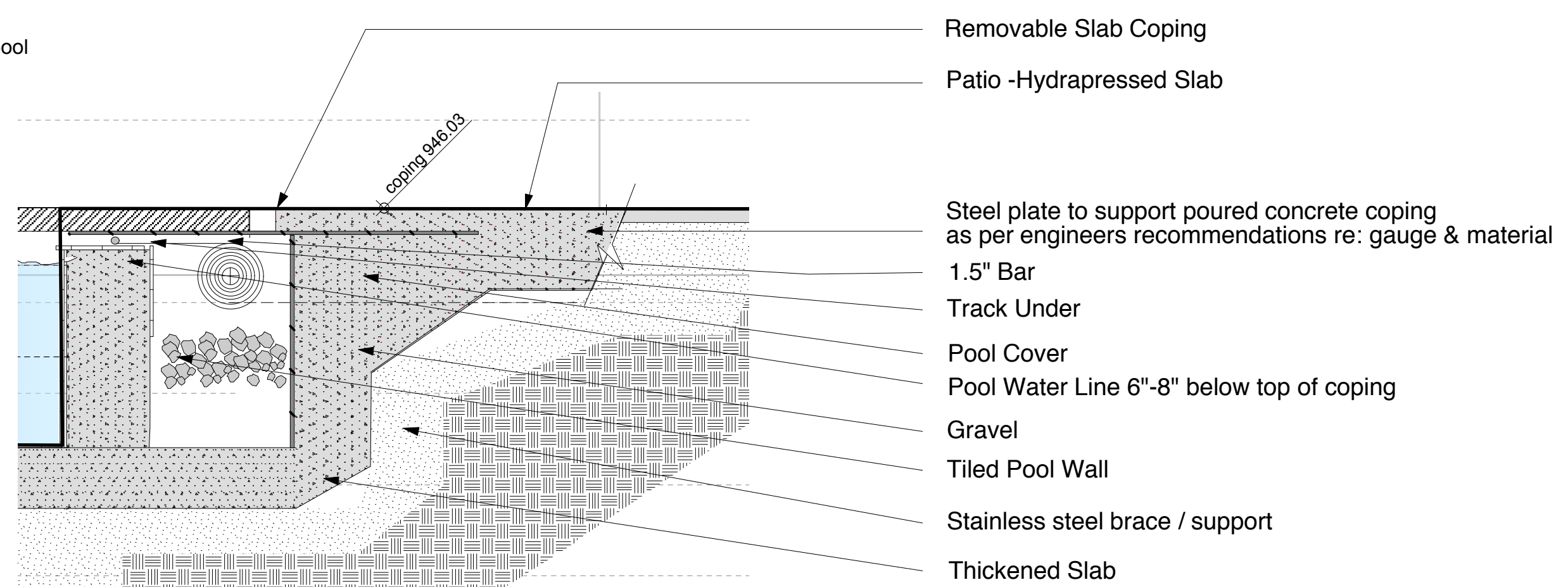

SECTION VIEW- POOL COVER CAVITY
SCALE: 3/4"=1'-0"

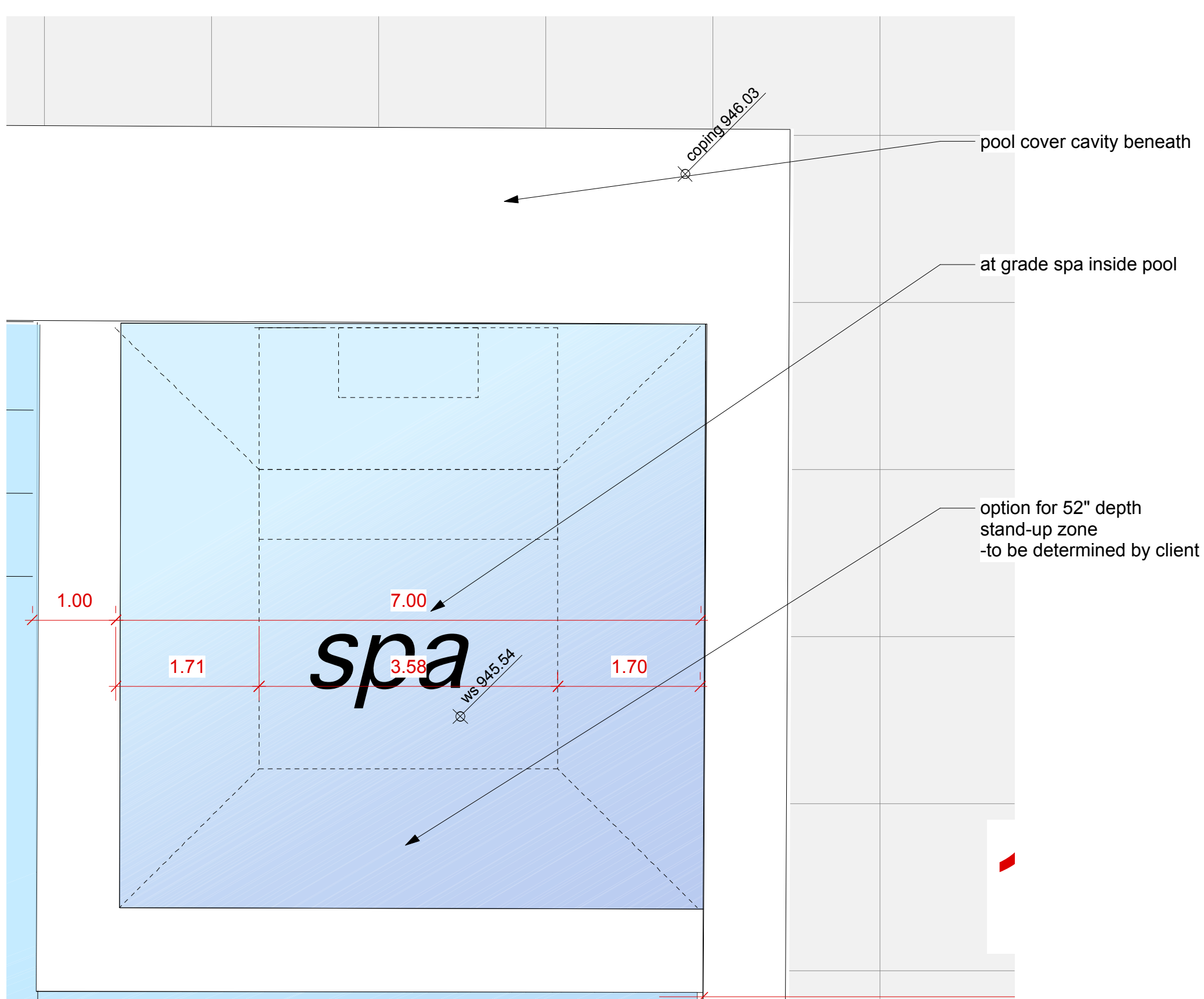

PLAN VIEW- SPA
SCALE: 3/4"=1'-0"

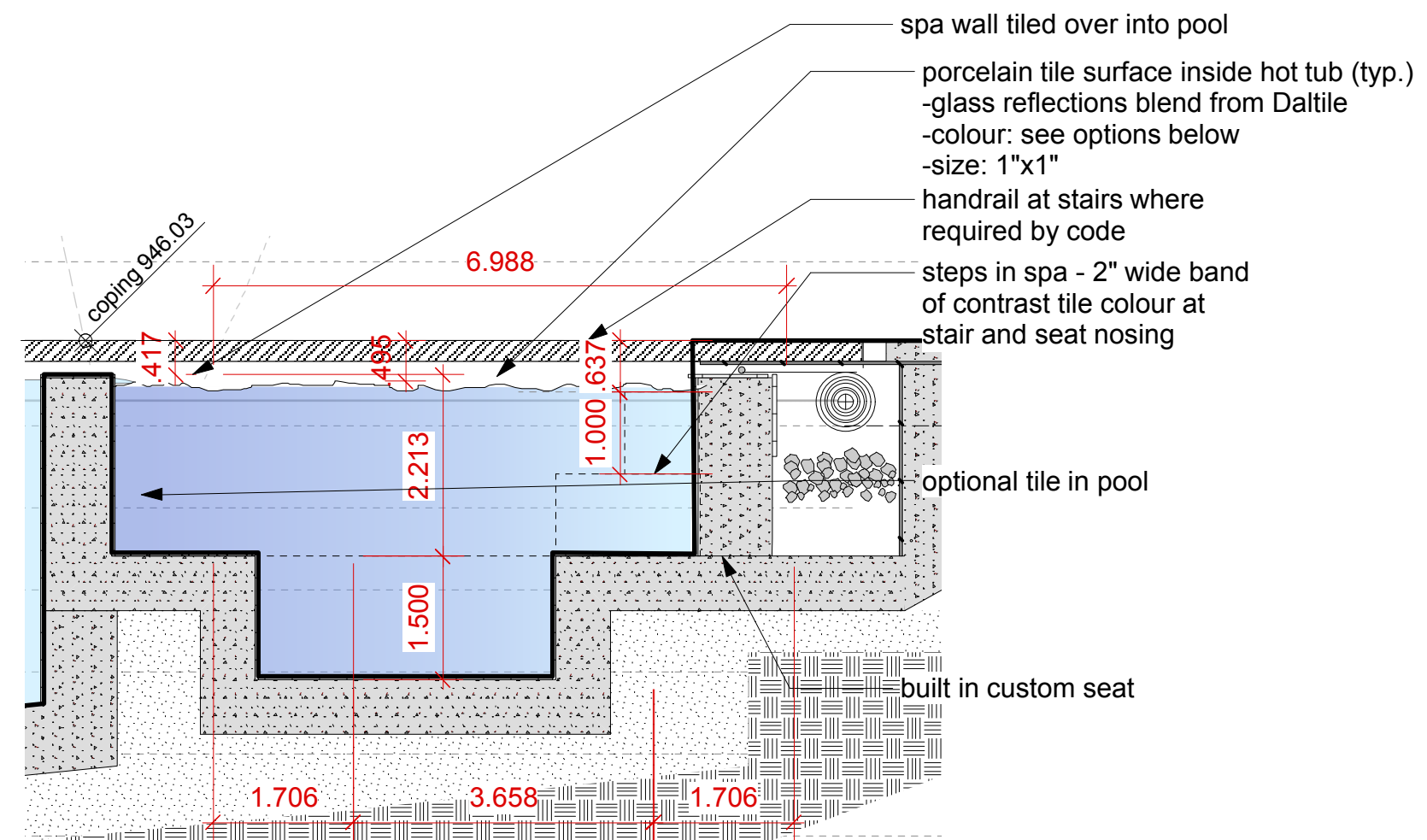

SECTION VIEW- SPA
SCALE: 1/2"=1'-0"

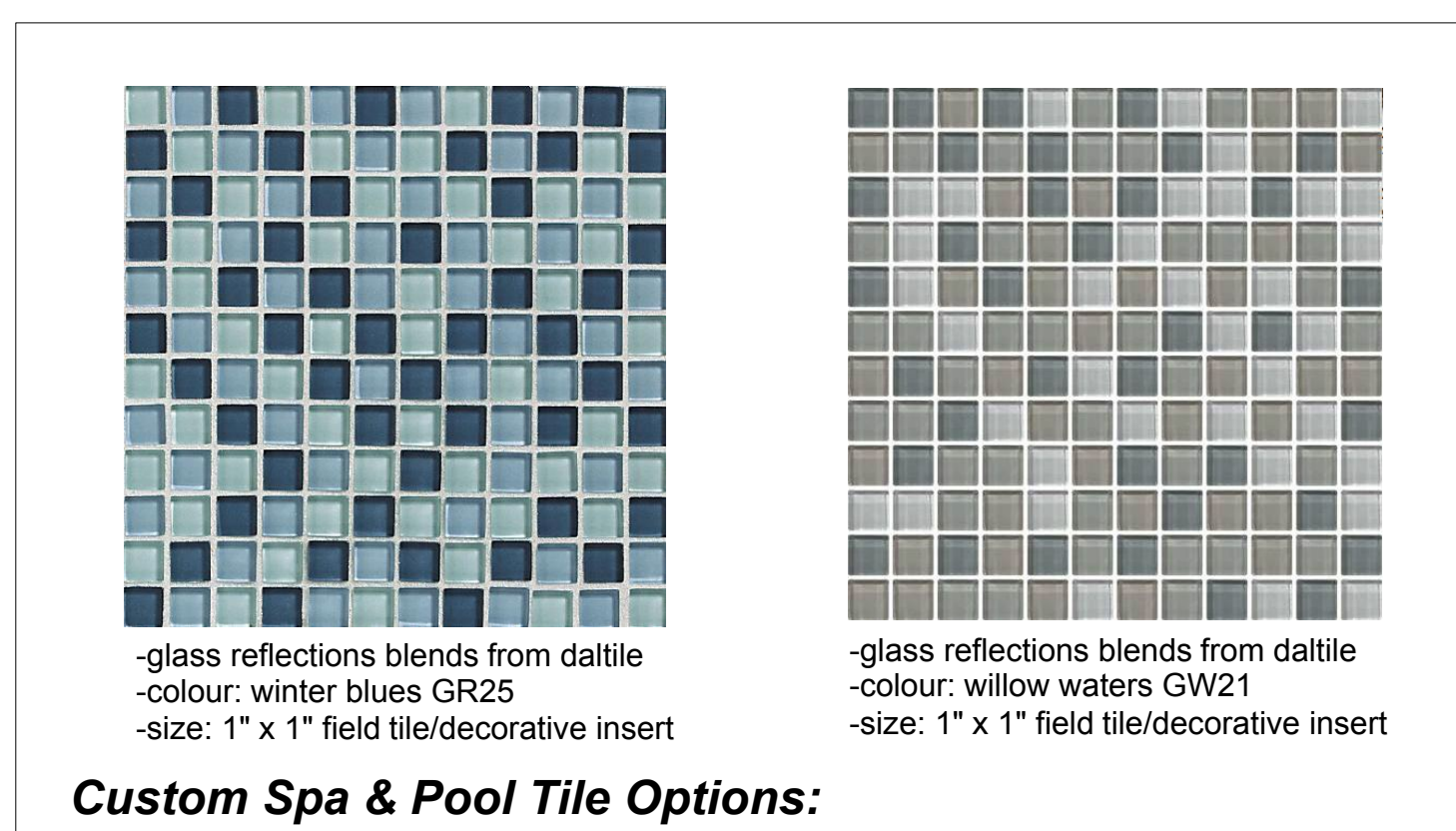

Custom Spa & Pool Tile Options:

FORMA DESIGN INC.
www.formadesign.ca

209-828 Harbourside Dr.
North Vancouver
British Columbia
Canada V7P 3R9
tel 604-986-9193 fax 604-986-7320

revisions:
1. for client review June 19, 2015
2. issue to BPP July 20, 2015

consultants:
CREKESIDE ARCHITECTS
INTERCAD CONSULTING

project:
RODGERS AREA 3
LOT 8
WEST VANCOUVER BC

sheet:
POOL DETAILS

drawn:
checked:
date:
scale:
as shown

Copyright reserved. This drawing and design is the property of Forma Design Inc. and may not be used without the written permission of Forma Design Inc.
Contractors shall verify and be responsible for all dimensions on the job and this office shall be informed of any changes made on site.

project no: sheet no:
L5.0 DETAILS